

# DAWSONS

Property Professionals since 1925

18/20 STAMFORD STREET STALYBRIDGE CHESHIRE TEL: 0161 338 2292

Website: [www.wcdawson.com](http://www.wcdawson.com) Email: [reception@wcdawson.com](mailto:reception@wcdawson.com)



## Rutland Street, Ashton-Under-Lyne, OL6 6TZ

This newly decorated, two-bedroom terraced property on Rutland Street, Ashton-under-Lyne, offers versatile living space with two reception rooms.

The home features fresh, neutral décor throughout, creating a bright and modern feel.

Galley Style Kitchen with Oven, hob & extractor. Two good size bedrooms. Bathroom with three piece suite & shower over. Low maintenance enclosed rear yard.

Perfectly positioned for easy access to both Ashton-under-Lyne and Stalybridge town centres, both offerings train stations with regular links into Manchester City Centre.

The property is conveniently located near Tameside General Hospital, local colleges, and several high-performing schools. Quick access to the M60 motorway network.

£ 925+ Holding Deposit

Council Tax Band A

Energy Efficiency Rating D

**£925 Per Calendar Month**



**CHARTERED SURVEYORS, ESTATE AGENTS  
& PROPERTY MANAGEMENT SPECIALISTS**



## Rutland Street, Ashton-under-Lyne, OL6 6TZ

- Newly decorated
- Galley Style Kitchen
- Stamford Park close by
- Two reception rooms
- GCH & DG
- Two well proportioned bedrooms
- Excellent transport links

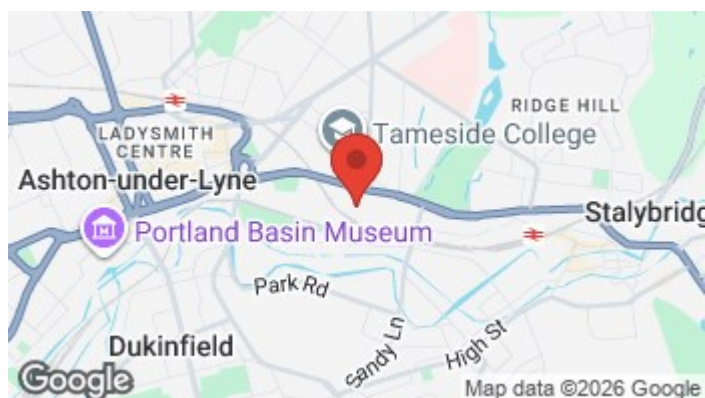

Directions



# Floor Plan

Ground Floor

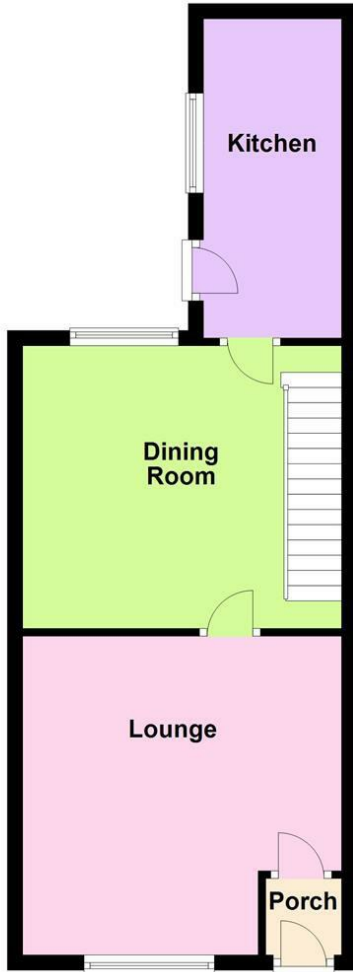

First Floor

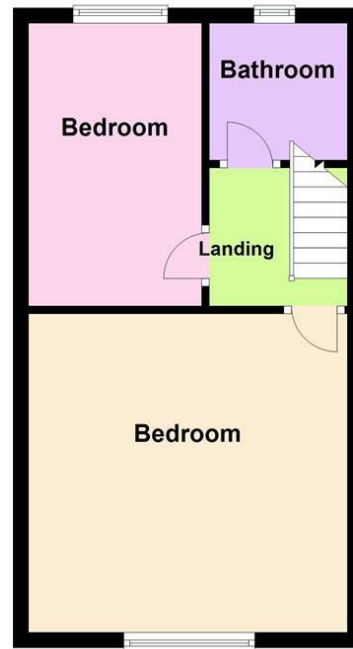

These particulars, whilst believed to be accurate are set out as a general outline only for guidance and do not constitute any part of an offer or contract. Intending purchasers should not rely on them as statements of representation of fact, but must satisfy themselves by inspection or otherwise as to their accuracy. No person in this firm's employment has the authority to make or give any representation or warranty in respect of the property.

